

NEW YORK YACHT CLUB

EGYPT/NILE EXPEDITION

JANUARY 29 – FEBRUARY 12, 2011

TOUR PRICING

Deck "D":	Chopin Suites:	403, 404	\$12,050.00 per person
Deck "D":	Beethoven Suites:	401,402,405-409 412,414,415	\$ 9,425.00 per person
Deck "D":	Mozart Suites:	410, 411	\$ 8,825.00 per person
Deck "C":	Beethoven Suites:	306,307,308,311 312,314,301,303,304	\$ 9,125.00 per person
Deck "C":	Mozart Suites:	309, 310	\$ 8,525.00 per person

The above rates include the following services:

- Meeting, assistance and individual transfers upon arrival and departure
- Porterage of one suitcase per person, throughout the expedition
- Services of two English speaking Egyptian guides
- One local tour manager throughout Egypt
- Five additional guides at the Cairo Museum
- Touring per itinerary in two deluxe private air conditioned busses
- All entrance fees and service charges based on listed touring
- Hotels as listed
- Sonesta Star Goddess Cruise – 6 night's private charter
- Internal flights: Cairo/Aswan/Abu Simbel/Aswan-Luxor/ Cairo
- All meals except lunch on February 10, lunch/dinner on February 11
- Private tent dinner with entertainment in desert
- Cocktail reception Mena House
- Cocktail reception Movenpick
- Tipping to all guides, escorts, drivers, porters, restaurant/ship staff
- Feluca races in Aswan
- Lecture fees

Not included in the rate: International Airfare is not included in the pricing.
Balloon ride over Luxor (\$135 per person), excess baggage charges, visa fees
Drinks at the tent party are as per consumption

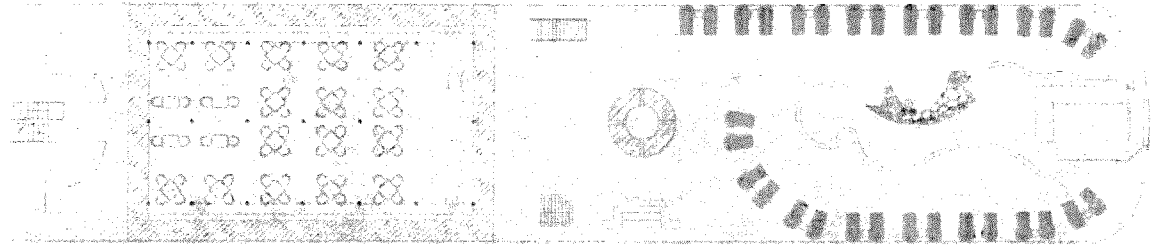

SUN DECK

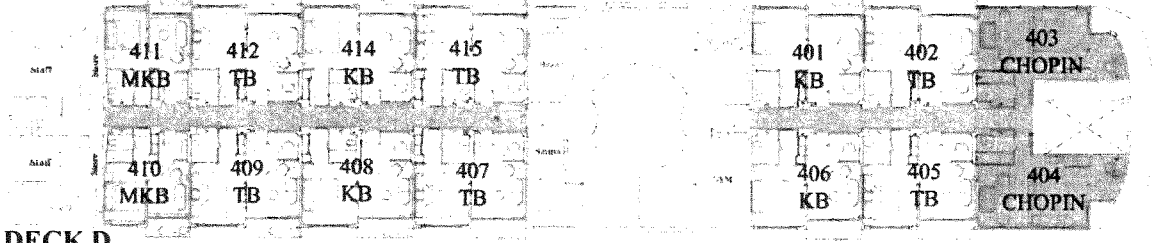

DECK D

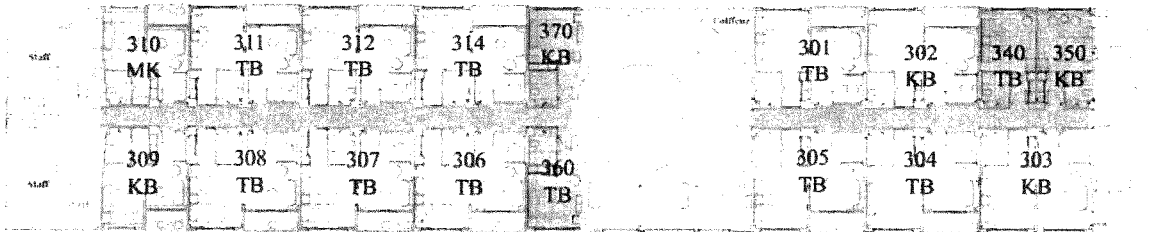

DECK C

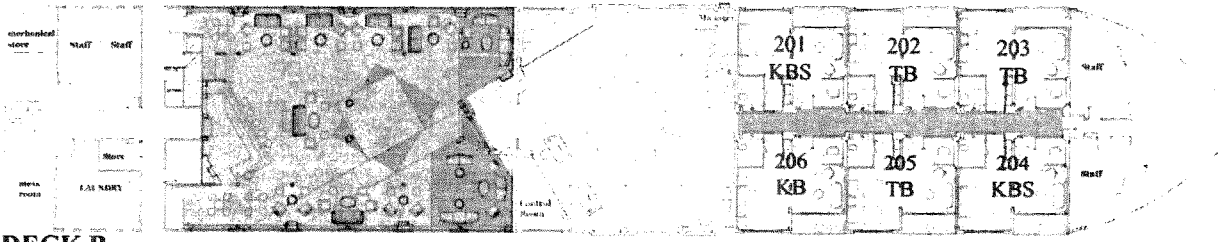

DECK B



DECK A